

**SUBMITTAL
DATA**

Schwank
INNOVATIVE HEATING SOLUTIONS



2300 SERIES

**HIGH EFFICIENCY / COMBINED INTENSITY
INFRA-RED PATIO HEATERS**

PROJECT:	
ENGINEER:	
CONTRACTOR:	
DISTRIBUTOR:	
SCHWANK MODEL #:	
FUEL:	
APPROVED BY:	
DATE:	
APPROVAL #:	



MEMBER OF



Canadian Restaurant
and Foodservices
Association

Association canadienne
des restaurateurs et des
services alimentaires



NOTICE:

Schwank reserves the right to make changes to equipment and specifications without obligation or notification. All codes are current at the time of printing.

This publication, or parts thereof, may not be reproduced in any form, without prior written consent from Schwank. Unauthorized use or distribution of this publication is strictly prohibited.

*Schwank
210 Brunel Road,
Mississauga, Ontario,
L4Z 1T5
phone: (905) 712-4766
fax: (905) 712-8336
<http://www.schwankheaters.com>
e-mail: info@schwank.on.ca*

*Schwank Inc.
PO Box 988
Waynesboro,
Georgia,
USA 30830
Phone: (706) 554-6191
Fax: (706) 554 9390
<http://www.schwankheaters.com>
e-mail: info@schwankheaters.com*

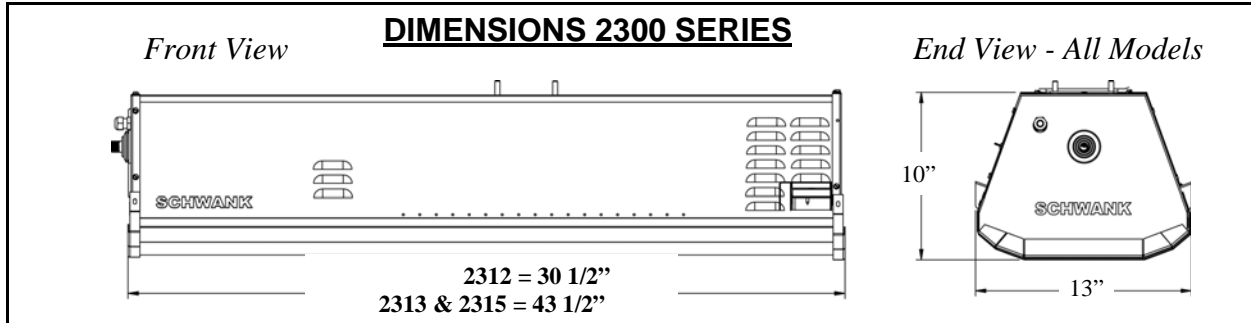

Number of Heaters	MODEL NO.	BTU/Hr	GAS	1/2" GAS INLET PIPE SIZE		MANIFOLD PRESSURE	ELECTRICAL	WEIGHT (LBS.)
				MINIMUM GAS LINE PRESSURE	MAXIMUM GAS LINE PRESSURE			
	2312-N	23,000	NAT	6" W.C.	14" W.C.	5" W.C.	VOLTAGE 24VAC	32
	2312-L	23,000	LP	11" W.C.	14" W.C.	10" W.C.		32
	2313-N	35,000	NAT	6" W.C.	14" W.C.	5" W.C.	CURRENT AMPS 40VA*	44
	2313-L	35,000	LP	11" W.C.	14" W.C.	10" W.C.		44
	2315-N	50,000	NAT	6" W.C.	14" W.C.	5" W.C.		48
	2315-L	50,000	LP	11" W.C.	14" W.C.	10" W.C.		48

* For a multiple heater installation, the first heater is sized at 40 VA and each additional heater at 20 VA. The sum total will be the required Transformer size. If total VA is between sizes, select the next highest VA rating.

MINIMUM CLEARANCES TO COMBUSTIBLES

The clearances to combustibles are established at points reaching a surface temperature of 160° F. Some materials such as awnings or plastic may require higher distances. Respect clearances as shown

MODEL NO		Ends	Horizontal			30° Angle			45° Angle	
		C	D	E	F	G	H	J	K	L
2312-N/L	OUTDOOR	3"	5.5"	7"	9.5"	1"	9.5"	12.5"	1"	11.5"
2312-N/L	INDOOR	4"	8"	10"	12.5"	2.5"	14"	16"	2"	15.5"
2313-N/L	OUTDOOR	5"	7.5"	9"	9.5"	1.5"	21"	10.5"	1.5"	23"
2313-N/L	INDOOR	6"	10.5"	14.5"	14.5"	2.5"	26"	17"	2.5"	28"
2315-N/L	OUTDOOR	16"	8"	13.5"	10"	2"	21"	12.5"	2"	24.5"
2315-N/L	INDOOR	17"	11"	19"	16.5"	3"	28.5"	18.5"	3"	30"

Horizontal Mounted

Angle Mounted 30° and 45°

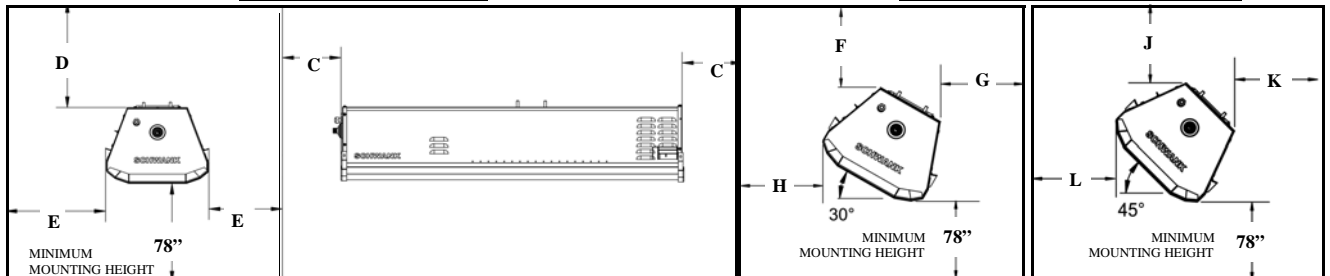

*For most perimeter mount applications, Schwank recommends a 30° mounting angle for best heating coverage - a 45° angle may direct a large portion of infrared heat above the heads of seated occupants.

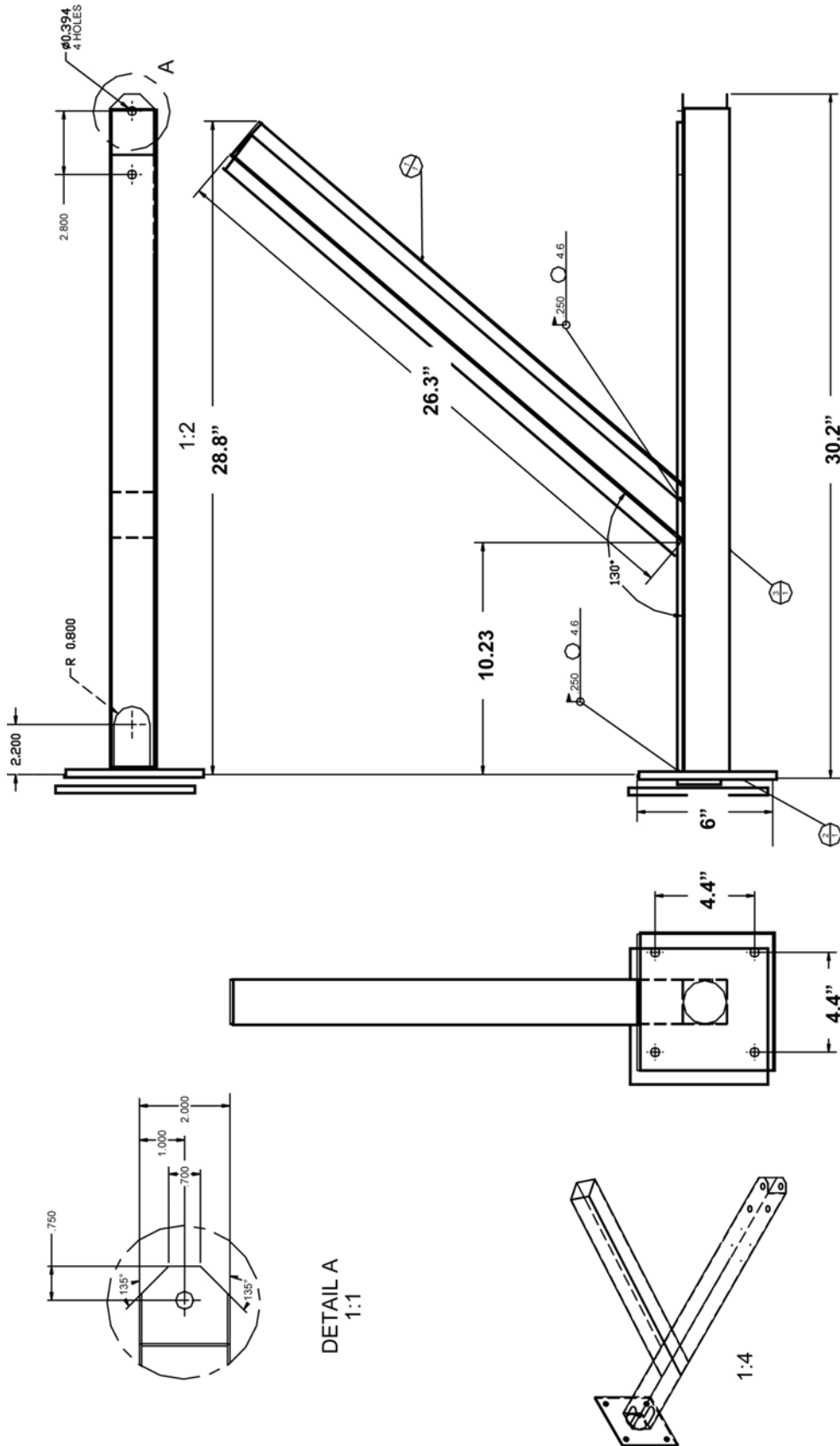

OPTIONAL 2300 / IO-210 MOUNTING ARM

2300 SERIES COMPONENT DESCRIPTION

IGNITION	DIRECT SPARK MODULE
COMBINATION GAS VALVE	24 VOLT <input type="checkbox"/> NATURAL GAS 5" W.C. MANIFOLD PRESSURE <input type="checkbox"/> PROPANE 10" W.C. MANIFOLD PRESSURE
WIND SCREEN	STAINLESS STEEL WITH BLACK EMISSIVE COATING
CABINET	<input type="checkbox"/> ALUMINIZED STEEL WITH BLACK POWDER COAT <input type="checkbox"/> STAINLESS STEEL WITH BLACK POWDER COAT
VENTURI TUBE	STEEL BUILT INTO BURNER HOUSING
BURNER	ONE BURNER WITH COMPLETE IGNITION / SENSING SYSTEM
CERAMIC TILE	SCHWANK EFFECT TILE 14/4 WITH INCREASED SURFACE INDENTATIONS AND HARD FINISHED EDGES
TILE RETAINERS	STAINLESS STEEL
COMBUSTION	"COLD STATE" COMBUSTION OF 1,100 DEGREES CELSIUS TO ENSURE MINIMUM EMISSIONS
CONTROL	<input type="checkbox"/> PATIO CONTROL PANEL 24 VOLT <input type="checkbox"/> REMOTE CONTROL