

Cabinet Order Form - Accepts Tile

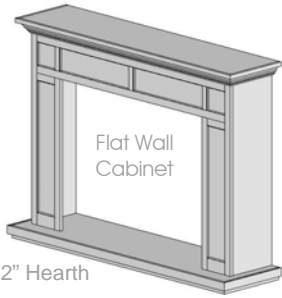

2" Hearth

Aspen (Recessed Panel)

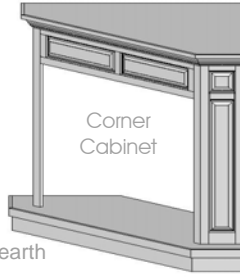

6" Hearth

Meridian (Raised Panel)

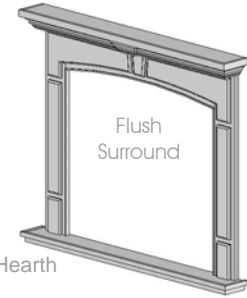

2" Hearth

Keystone (Arched Raised Panel)

Dealer: _____ PO # _____

City: _____ State: _____ Contact: _____

IS THE ABOVE PO # PART OF A LARGER PO THAT IS ALSO BEING FAXED TO US AT THIS TIME? YES NO

- Circle choices below and include part numbers -

Fireplace Model Number: _____

Ordering Part #

Cabinet Name, Type & Wood: (Circle Three) (• Aspen • Meridian • Keystone)

(• Flush Surround • Wall Cabinet • Corner Cabinet • Pier Cabinet) (• OAK • MAPLE) # _____

Cabinet Tile Kit Color & Overlap: (Circle Two)

(• RUST • BLUE-GRAY • WARM GREEN • BEIGE • NONE)

(• 1/2" Face-Overlap Tile* • Full Face-Overlap Tile*) # _____

Cabinet Stain:

• SPECIAL WALNUT • GOLDEN OAK • DARK WALNUT • SEDONA RED

• EBONY DISTRESSED FINISH • ANTIQUE WHITE • CLEAR COAT • UNFINISHED # _____

Hearth Option: (All have 6" reveal)

• 2" HIGH • 6" HIGH

Hearth Tile Kit Color:

• RUST • BLUE-GRAY • WARM GREEN • BEIGE • NONE

Hearth Stain:

• SPECIAL WALNUT • GOLDEN OAK • DARK WALNUT • SEDONA RED

• EBONY DISTRESSED FINISH • ANTIQUE WHITE • CLEAR COAT • UNFINISHED # _____

12" Individual Tile: (Minimum order quantity: 6)

• RUST • BLUE-GRAY • WARM GREEN • BEIGE **QUANTITY:** (_____)

Cabinet Tile Backers (Only): (FOR INSTALLATION EASE WHEN SUPPLYING YOUR OWN TILE)

• 1/2" FACE OVERLAP* • FULL FACE OVERLAP* # _____

Face-Overlap refers to how much tile will overlap the top/side face pieces of the fireplace (1/2" face overlap only for #944 cabinet)

- Please proof this order form carefully and review your Order Confirmation when faxed to you - Cabinetry is non-returnable -